



Clinical
Best
Practice
Institute

Support for Therapists, Supervisors, & Businesses

Not Your *Typical* Therapist

Conference Agenda · April 23–25, 2026

Sonesta Suites at Gainey Ranch, Scottsdale, AZ

DAY 1

Thursday, April 23

7:45–4:30	Check Out Our Conference Exhibitors <i>Terrace Boardroom & Patio</i>
7:45–8:30	Check In / Breakfast <i>Lobby & Hearth Room</i>
7:45–8:30	Pick Up Your Name Badge & Conference Tote <i>McDowell Room</i>
8:30–8:45	Kickoff — Patricia Dobratz <i>Gainey Ballrooms A–C</i>
8:45–10:00	Ketamine-Assisted Psychotherapy — Jamie Born, LCSW <i>Gainey Ballrooms A–C</i>
10:00–11:15	EMDR, Brainspotting & Deep Brain Reorienting — Venessa De La Cruz, LCSW, PMH-C <i>Gainey Ballrooms A–C</i>
11:15–12:15	Lunch <i>Hearth Room</i>
12:15–1:30	IFS, Parts Work & Ego States — Melanie Scott, LMFT <i>Gainey Ballrooms A–C</i>
1:30–2:45	Integration of Attachment Theory — Amanda Mowbray, LMFT <i>Gainey Ballrooms A–C</i>
2:45–3:00	Break / Snack <i>Hearth Room</i>
3:00–4:15	Start with Compassion: Foundations of Grief Affirming Practice® — Terri Waibel, LCSW, FT <i>Gainey Ballrooms A–C</i>
4:15–4:30	Stop by the exhibitor tables on your way out! <i>Terrace Boardroom & Patio</i>

DAY 2

Friday, April 24

7:45–4:30	Check Out Our Conference Exhibitors <i>Terrace Boardroom & Patio</i>
7:45–8:30	Check In / Breakfast <i>Lobby & Hearth Room</i>
8:30–8:45	Welcome — Patricia Dobratz & Chrissy Veith from the Meadows <i>Gainey Ballrooms A–C</i>
8:45–10:00	The Intersect of Ethics, Technology & Behavioral Health — Patricia Dobratz, JD, LMFT <i>Gainey Ballrooms A–C</i>
10:00–10:15	Break
10:15–12:00	The Intersect of Ethics, Technology & Behavioral Health (continued) — Patricia Dobratz, JD, LMFT <i>Gainey Ballrooms A–C</i>
12:00–1:00	Lunch <i>Hearth Room</i>
1:00–2:15	Working with Neurodivergent Clients in Therapy — Casey Heinsch, LMFT <i>Gainey Ballrooms A–C</i>
2:15–2:30	Break / Snack <i>Hearth Room</i>
2:30–4:15	Working with Neurodivergent Clients in Therapy (continued) — Casey Heinsch, LMFT <i>Gainey Ballrooms A–C</i>
4:15–4:30	Stop by the exhibitor tables on your way out! <i>Terrace Boardroom & Patio</i>



DAY 3

Saturday, April 25

7:45–8:30

Check In / Breakfast
Lobby & Hearth Room

8:30–10:00

Business Operations Panel — Moderated by Ashlea Taylor Barber, LMFT
Gainey Ballrooms A–C

10:00–11:30

Regulatory Panel — Moderated by Jade Rice, LMFT
Gainey Ballrooms A–C

11:30–11:45

Break / Snack
Hearth Room

11:45–1:00

Self Care Wellness Stations

Attendees are encouraged to rotate through our Self Care Wellness Stations approximately every 15 minutes.

- Networking and Making Connections (Hearth Room)
- Take advantage of one of the massage chairs (Terrace Room)
- Pamper yourself with glam by Trish McEvoy (McDowell Room)
- Breathwork with Dr. Amy Bjorkman (Gainey Room A)
- Movement with Tee Jay Netters, LMFT (Gainey Room B)

Venue Map — Sonesta Suites at Gainey Ranch (see below)

7300 E. Gainey Suites Drive | Scottsdale, AZ 85258

WiFi Network: Sonesta_Conference Wi-Fi

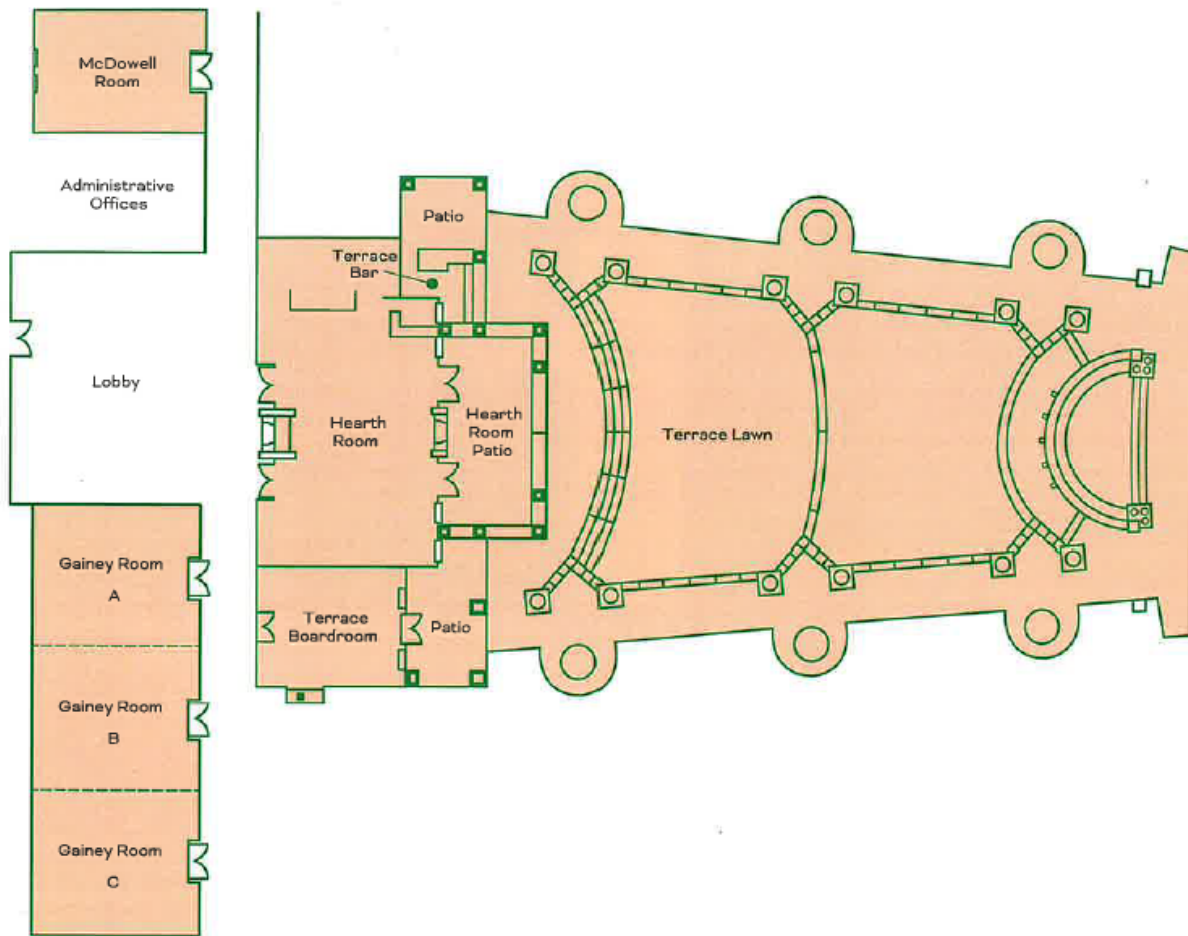

Clinical Best Practice Institute, LLC has been approved by NBCC as an Approved Continuing Education Provider, ACEP No. 7639. Programs that do not qualify for NBCC credit are clearly identified. Clinical Best Practice Institute, LLC is solely responsible for all aspects of the programs.